

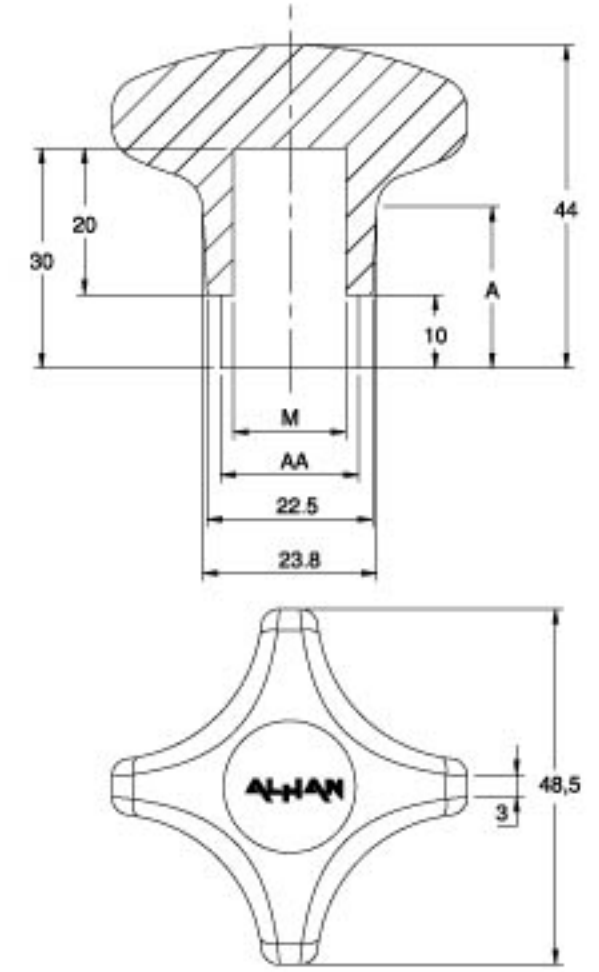

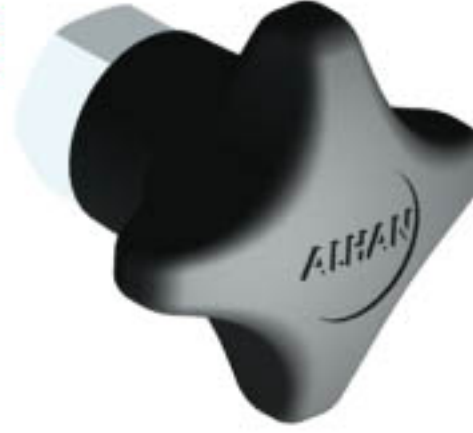

210 DIŞI TUTGAÇLAR/KNOBS

🔧 Güçlendirilmiş Polyamid+Krom Kaplama/Reinforced Polyamide (PA6)+Bushings in Nickel Plated Brass

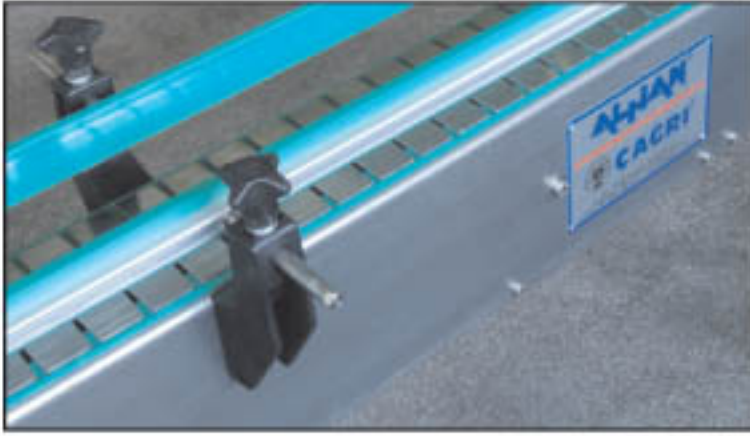

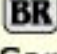

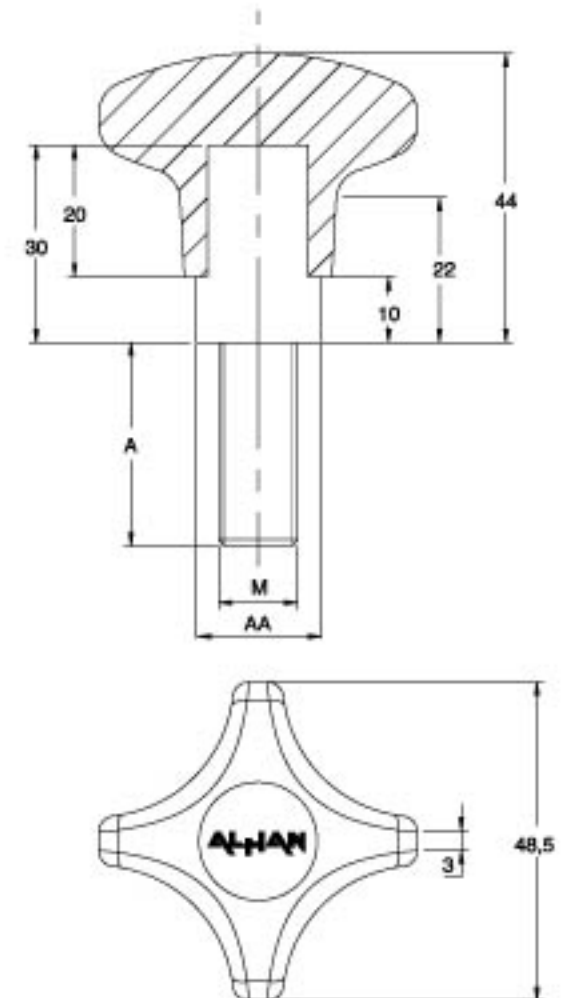

M	AA	A	Malzeme/Material		Kg	Stok Kod Stock Code	📦				
											
M6	19	24	Güçlendirilmiş Polyamid Reinforced Polyamide		0,065	210 D06 024	100				
M8	19	24									
M10	19	24									
M12	19	24									
M6	19	24						Turuncu Orange		0,065	210 D06 124
M8	19	24									
M10	19	24									
M12	19	24									
M6	19	24	Siyah Black		0,065	210 D06 124					
M8	19	24									
M10	19	24									
M12	19	24									

210 ERKEK TUTGAÇLAR/KNOBS

🔧 Güçlendirilmiş Polyamid+Krom Kaplama/Reinforced Polyamide (PA6)+Bushings in Nickel Plated Brass



M	AA	A	Malzeme/Material		Kg	Stok Kod Stock Code	📦		
									
M6	19	15	Güçlendirilmiş Polyamid Reinforced Polyamide		0,065	210 E06 015	75		
M6	19	20			0,065	210 E06 020	75		
M8	19	20			0,065	210 E08 020	75		
M8	19	25			0,070	210 E08 025	75		
M8	19	30			0,070	210 E08 030	75		
M10	19	25			0,080	210 E10 025	60		
M10	19	30			0,080	210 E10 030	60		
M12	19	25			0,090	210 E12 025	50		
M12	19	30			0,090	210 E12 030	50		
M6	19	15			Turuncu Orange		0,065	210 E06 115	75
M6	19	20					0,065	210 E06 120	75
M8	19	20					0,070	210 E08 120	75
M8	19	25	0,070	210 E08 125			75		
M8	19	30	0,070	210 E08 130			75		
M10	19	25	0,080	210 E10 125			60		
M10	19	30	0,080	210 E10 130			60		
M12	19	25	0,090	210 E12 125			50		
M12	19	30	0,090	210 E12 130			50		

Renk seçenekleri bulunur./On request by changable colour.
 Özel üretim yapılır. / On request by manufactured.